

URT-20-5K / FS200

DUAL-AXIS LOAD CELL

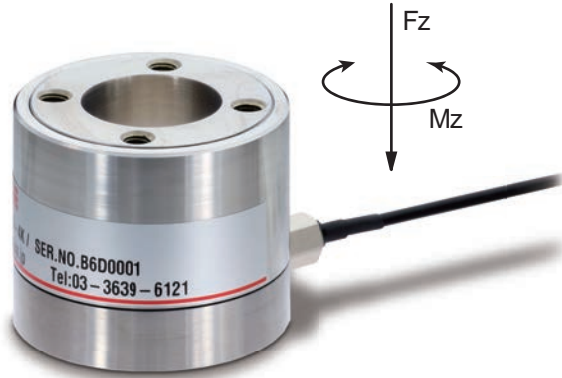

Product-specific amplifier

Rated Output is adjusted at $\pm 5V$ in both Mz and Fz direction.
Just connect a sensor and apply 24V to it, then adjusted voltage will be outputted simultaneously.
Any calibration settings are not required.

DUAL-AXIS LOAD CELL URT-20-5K

Thrust force and Torque are measured simultaneously.

Phenomenal safe overload!!

URT-20-5K is a dual-axis load cell

having 2kHz high-speed responsivity and high-rigidity.

Attached cable

Connector (Plug)
PRC05-P8M

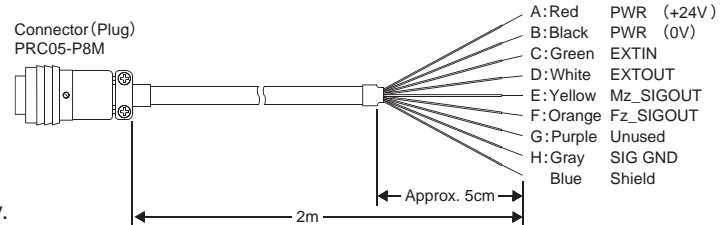

Specifications

Model	Sensor : URT-20-5K, Amplifier : FS200
Rated capacity	Mz : $\pm 20Nm$ Fz : 5kN
Power supply voltage	DC24V $\pm 15\%$
Consumption current	150mA or less
Load signal output	Mz, Fz : $\pm 5V$
Load resistance	2k or more
Response	2kHz
I/O signal	Input: Auto zero command Output: Auto zero response
Safe overload	Mz : 500%FS Fz : 400%FS
Non-linearity	Mz : 0.1%FS typ. Fz : 0.5%FS
Hysteresis	Mz : 0.1%FS typ. Fz : 0.5%FS
Repeatability	Mz : 0.1%FS typ. Fz : 0.5%FS
Cross talk	Mz(20Nm) Fz : 0.05kN or less Fz(5kN) Mz : 0.2Nm or less
Compensated temp. range	0 to +40°C
Safe temp. range	-10 to +50°C
Temp. effect on zero	0.1%FS/°C
Temp. effect on span	0.05%FS/°C
Sensor material	Stainless steel
Weight	Sensor : Approx. 250g, Amplifier : Approx. 180g (Excluding the cable)

* Above specifications are achieved when the sensor(URT-20-5K) is connected with the dedicated amplifier(FS200).

* Accuracy is not guaranteed in the range of Fz 0 to -5V.

External dimension

URT-20-5K

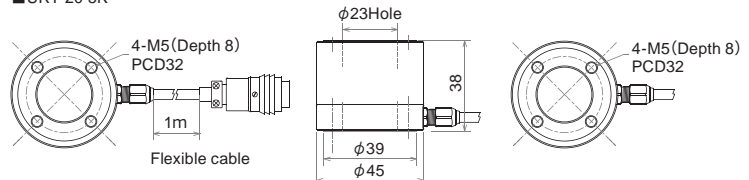

FS200

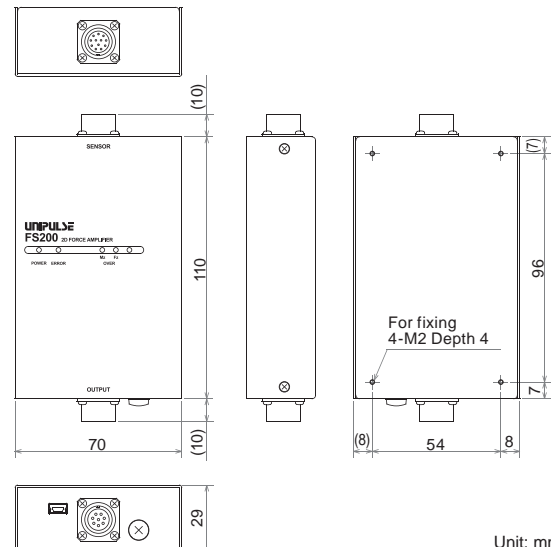

Unit: mm